

**VIDYASAGAR BANK**  
**SCHEDULE FOR FURNISHING**

OF ORIGINAL SERVIER ROOM, OFFICER, CLARICAL TABLE ETC. EXECUTIVE TABLE, PARTITION MAKING AND  
FILE CABINET ALLIED WORKS

AT : H.O. :: MEDINIPUR

Sl.No.	DESCRIPTION OF ,WORKS	Qty.
1	a)Supplying for <b>main entrans door</b> made of 50mm thk well seasoned teak wood of special design for top and bottom stiles, fixed portion with 8mm thk. clear float glass and open sutable portion with 12mm thk clear float, glass, necessary hardware fixtures of approved make and design.	60.00 sft
	Floor spring machin Godraj	2.00 pcs
2	P&F. of <b>glazed full / Semi ht. partition for Manager's &amp; Server's chamber</b> consisting of 6 mm ply on both faces over the sal wooden frame(2"x2") @2'-0"c/c(both way) duly laminated by 1.0mm thk.lam sheet of uniform grooves (i.e.2.5mm thk.) where the lower part upto 3'-0" and upper part above 7'-0"ht. shall be solid and middle part shall be glazed by 8mm thk.glass(plain)incl. glazed door of same pattern.There shall be etching of simple design on front glass partition & door glass and shall have 6" skirting of diff. colour in lamination.The rate shall be inclusive of all fittings, locks, handle & hinges complete by t.w.moulding (1.5"x1") for fixing glasses duly well finished of wood colour polishing	1000.00 sft
3	Supplying <b>opeck Low height partitions</b> (upto max. 1200 to 2250 mm high) as per following specification: Basic frame work: well hard wood frem works (2" x 2") duly covered by 6 mm ply on both faces over laminated sheet of approved shade & color having glass fixing by wooding beating duly polish finished.	450.00 sft
4	Supplying for <b>Flush door</b> shutter 37mm thk over laminate sheet of approved shade both faces of the fitting steel hinges, with handle of approved make and quality.	130.00 sft
5	Suppling of <b>Daftari/ Attendent tables</b> The basic structure or 19mm thk BWR grade block board for sides, top and modesty panel, finished with 1.0 mm thk laminate sheet of approved shade The drawer-cum-cabinet unit of (400 x 500 mm) drawar 12/6mm, thk ply finished by duly liminated approved shade shall be painted with 2 costs of white synthetic enamel paint over a coat of wooden primer and eage finished polished.	8.00 Nos
6	Supplying <b>12MM thk. GLASS WITH POLISH :</b>	160.00 sft
7	Suppling <b>Admin table</b> . The basic structure or 19mm thk BWR grade block board for sides, top and modesty panel, finished with 1.0 mm thk laminate sheet of approved shade The drawer-cum-cabinet unit of (400 x 500 mm) drawar 12/6mm, thk ply finished by duly liminated approved shade shall be painted with 2 costs of white synthetic enamel paint over a coat of wooden primer and eage finished polished.(7x3x2.5)	1 pcs
8	Supplying <b>side/back/front cabinet</b> : unite with shutters basic frem 19mm thik. BWR grade block B-board's finished by laminated sheet approvated clour having front edges polished finished (2.5X3.0X14")	24 sft
9	Suppling <b>B.D Table</b> . The basic structure or 19mm thk BWR grade block board for sides, top and modesty panel, finished with 1.0 mm thk laminate sheet of approved shade The drawer-cum-cabinet unit of (400 x 500 mm) drawar 12/6mm, thk ply finished by duly liminated approved shade shall be painted with 2 costs of white synthetic enamel paint over a coat of wooden primer and eage finished polished.(6x3x2.5)	1 pcs
10	Supplying <b>side/back/front cabinet</b> : unite with shutters basic frem 19mm thik. BWR grade block B-board's finished by laminated sheet approvated clour having front edges polished finished.(2.5X3.0X14")	120 sft
11	Suppling <b>Officers tables</b> . The basic structure or 19mm thk BWR grade block board for sides, top and modesty panel, finished with 1.0 mm thk laminate sheet of approved shade The drawer-cum-cabinet unit of (400 x 500 mm) drawar 12/6mm, thk ply finished by duly liminated approved shade shall be painted with 2 costs of white synthetic enamel paint over a coat of wooden primer and eage finished polished.(5x2.5x2.25)	20 pcs

Sl.No.	DESCRIPTION OF ,WORKS	Qty.
12	Supplying of <b>server room table</b> . The basic structure or 19mm thk BWR grade block board for sides, top and modesty panel, finished with 1.0 mm thk laminate sheet of approved shade The drawer-cum-cabinet unit of (400 x 500 mm) drawar 12/6mm, thk ply finished by duly liminated approved shade shall be painted with 2 costs of white synthetic enamel paint over a coat of wooden primer and eage finished polished (4.50X2.50X2.50)	8.00 pcs
13	Supplying <b>side/back/front cabinet</b> : unite with shutters basic frem 19mm thik. BWR grade block B-board's finished by laminated sheet approvated clour having front edges polished finished.(2.5X3.0X14")	120.00 sft
14	Supplying <b>wall mounted customer's writing desk</b> basic frem 19mm thk B/B duly laminated approved shed top 12 mm thk glass.	2 Nos
15	Supplying <b>notice board</b> as per following Size : 1200 x 900 Basic frame work hard wood sections over 6mm ply both faces finishing by 12.5mm thk. insulations board/ soft board covered by clothes sutable Mayrun clour having.	5 pcs
16	<b>Supplying of Vertical blinds</b> having 25mm high grade aluminium alloy slats with 0.19mm thickness. He head channel should be of GI steel U-shaped PU powder coated fitted with guardian filter having Tarnished steel housing and self lubricating nylon automatic disengaging worm and gear mechanism, all the fixtures in the top rail i/c drums, cradle, tile rod, etc. will be of Tarmished steel with 19mm bottom rail made of GI steel in matching color. He slat is to be placed on braided polyester yarn. The top rail is to be fixed on GI steel "L" shaped swivel bracket to hold, head channel. The blind will be in approved color shade.	400.00 sft
17	<b>Column and wall panelling</b> Basic Frame : 12mm thk. BWR plywood formed as per instruction. Finishing duly laminated by approved shed.	230.00 sft
18	Supplying for <b>Godrej lock</b> as per above specification.	8 pcs
19	Supplying <b>side/back/front cabinet</b> : unite with shutters basic frem 19mm thik. BWR grade block B-board's finished bt laminated sheet approvated clour having front edges polished finished.	240.00 sft
20	Supplying for <b>suggestion/cheque drop box</b> made of 19mm thk phenol formaldehyde bonded ply board and the curve portion at top made out of 90mm x 90- mm C. P. teak wood section. A slit opening of 10mm X' 150mm is to be provided at the top of the box. An open able shutter of 259mm x 262mm size made of 19mm thk phenol formaldehyde bonded block board is to be provided at 150mm above finished floor level. All the exposed timber surfaces i/c all free edges are to be finished with 1.0 thk. Laminate sheet of combination shade inner faces of block board surfaces are to be finished with minimum 2 coats of synthetic enamel paint of approved shades and quality over a coat of approved primer.	2 pcs
21	<b>Etching glass</b> for Manager and server main entrance door.	130.00 sft
22	Supplying for <b>CPU stand</b> basic frem 19mm ply b/board finished by synthetic enamble paint.	30 pcs
23	<b>Foot Rest</b>	30 pcs
The Quantities are Measured Approximately. Actual quantities may vary during compilation. Bill will be paid after measurement.		
<b>TOTAL</b>		

NB:

**GST EXTRA**

Vidyasagar Central Co-operative  
Bank Ltd., Midnapore  
Head office: - Midnapore  
At & P.O. - Midnapore,  
Dist. - Paschim Medinipur  
Memo- Dev / 73



Telephone – 03222–275417, 275411  
FAX - 03222 - 275411  
E-mail – vccbmidnapore@gmail.com

Date- 18/06/2018

## **Notice Inviting Quotation**

**Notice inviting quotations for Supplying, Fixing for Renovation of Wooden Counter Works at H.O. Vidyasagar CCB Ltd., at Midnapore, PO: Midnapore, Dist.: -Paschim Medinipur.**

**Sealed item rate quotations are hereby invited from reputed & experienced person /Supplier/Vendor/ Agencies.**

**Name of work: - Supplying, Fixing terms of Renovation of Wooden works by making Full Height Partitioning and Over Head Cabinet making and Executive and Clerical Table etc. at Head Office of Vidyasagar CCB Ltd., at Midnapore, PO: Midnapore, Paschim Medinipur.**

*Completion time:- 90 days from the date of issue of Work Order .*

*Last date & time of submission of Quotation:- 06/07/2018 up to 12 noon*

*Date & time of Opening of Quotation:- 06/07/2018 at 3 pm*

*Approximate Budget for The Work : Rs. 16.5 Lakh Only*

### **Terms & condition :**

**Supporting documents should be submitted against their qualification and also will have to be submitted PT , Trade license, PAN CARD, GST Registration Certificates.**

- 1) All bid must be accompanied by a refundable earnest money / bid security amount to Rs.15000/- as mentioned in the form of Bank Draft / Bankers Cheques in favour of Vidyasagar Central Co- Operative Bank Ltd., Midnapore **(To be deposited to A/C No:123005627958, IFSC: WBSC0VCCB01)**
- 2) The quotation should indicate specifically the basic price ,taxes, other duties if any no additional information will be entertained after due date.
- 3) No revision of rates shall be allowed except taxes / charges levied by the Central / State by dully notified only.
- 4) No advance or running payment shall be made. Payment shall be released after the satisfactory supply.
- 5) No deviation from the specification shall be allowed without prior consent of authority.
- 6) The contractor shall make arrangements for storage of material, tools and equipment etc at the site and Bank shall not bear any expenses and risks also on this account.

- 7) The contractor shall observe all necessary precautions at his cost to safeguard the workers during execution of work.
- 8) 90% payment against inspection acceptance delivery and completion of works and balance 10% will be paid after 6 months of warranty period. And also that the Payment will be made on successfully completion of work as per work order through account payee cheque or by transfer through NEFT/ RTGS .
- 9) The undersigned is the accepting authority who reserves the right to reject any or all quotations without assigning any reason and any notice or he will not bound to accept either the lowest tender at any of the bidders.
- 10) The Cost of Forms of amounting Rs. 100.00 to be submitted for each bid.( To be deposited to: A/C No: 602100007979; IFSC: WBSC0VCCB01).

**For further details please contact P& D Section , H.O. Midnapore or see notice Board of the Bank .**

**Date:- 18/06/2018**

**General Manager**

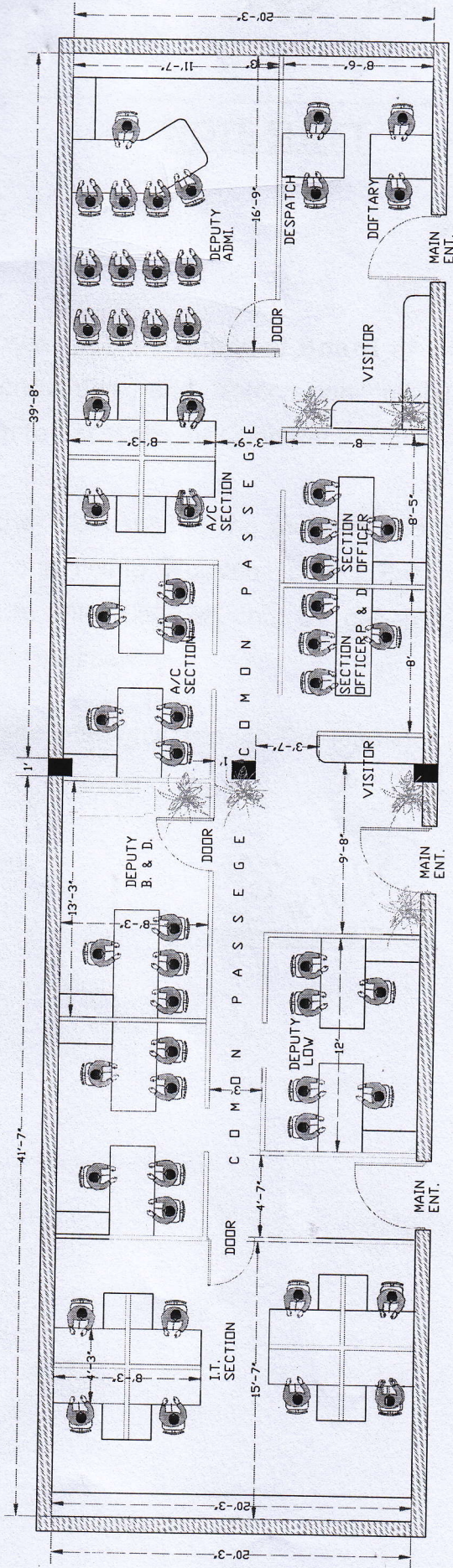

PROPOSED LAYOUT PLAN OF OFFICE

*Travis Adams*  
18/06/18